

Compact design for optimal space utilization and maneuverability.

Redesigned smartPILOT for improved ergonomics and intuitive operation.

Sensor-activated speed reduction for reliable truck-trailer entry (optional).



## ERE 125i/225i

Electric pedestrian pallet trucks (5,500 lb.)

**Variable and versatile for a wide range of applications.**

The flexible and powerful ERE 125i/225i electric ride-on pallet trucks combine proven technology with innovative features specifically tailored to the demands of modern warehouse logistics. The wide variety of stand-on platforms offer custom solutions for different application scenarios. The compact design, with a reduced front

end length, allows optimal utilization of warehouse space and provides excellent maneuverability in confined spaces. With their modular system, these trucks are extremely flexible and can adapt to your individual requirements. With a variety of added features, the pallet truck can be configured to help meet your application requirements.

The revised smartPILOT allows operation from both sides with automatic center positioning. Optimized access to the comfort charging socket ensures added user experience. These innovative features enhance efficiency, ergonomics in your warehouse.



# ERE 125i

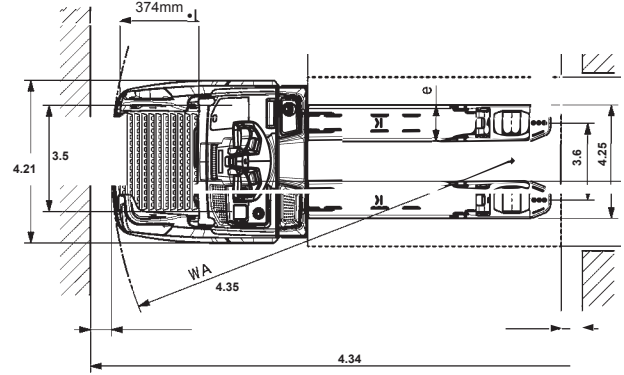
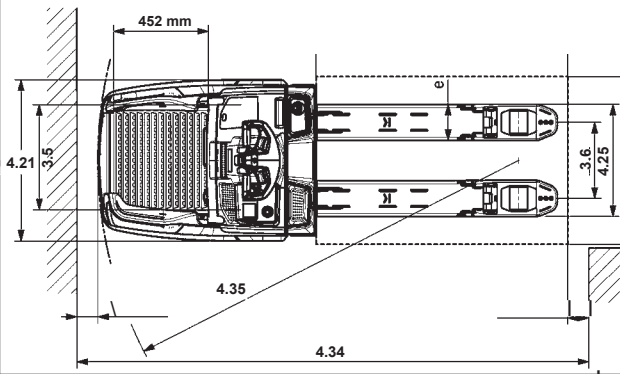
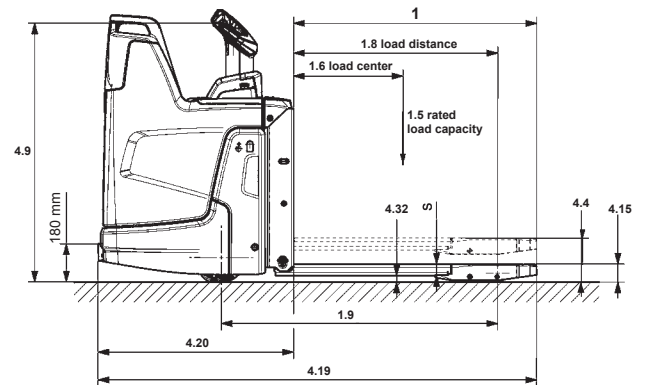
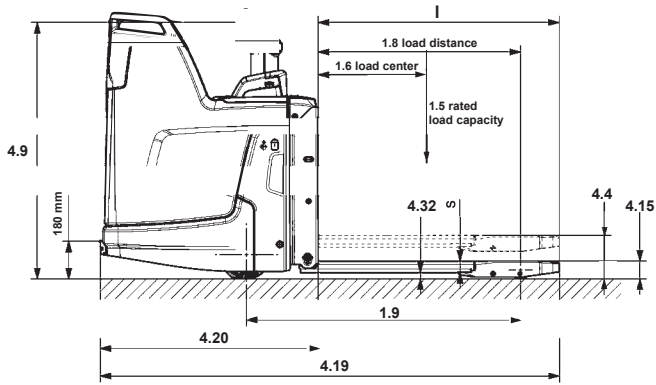

# ERE 225i

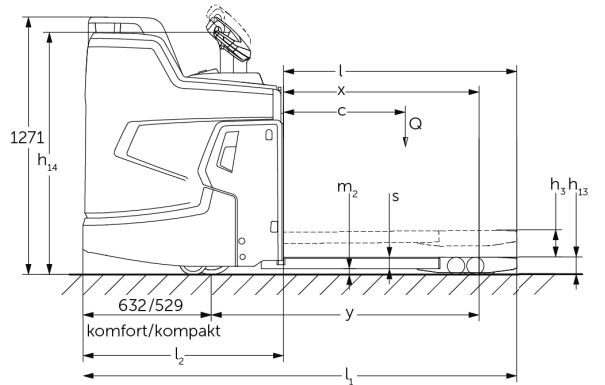
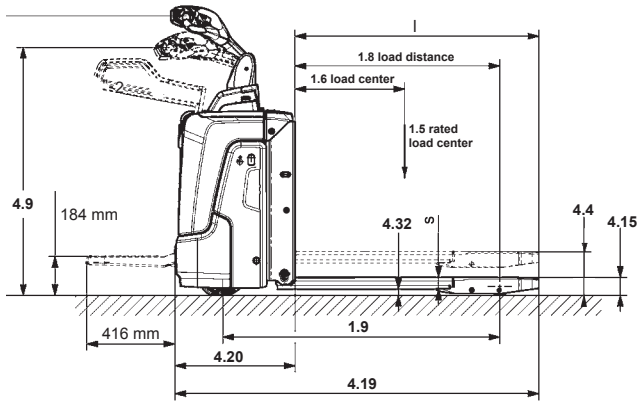

ERE - folding platform

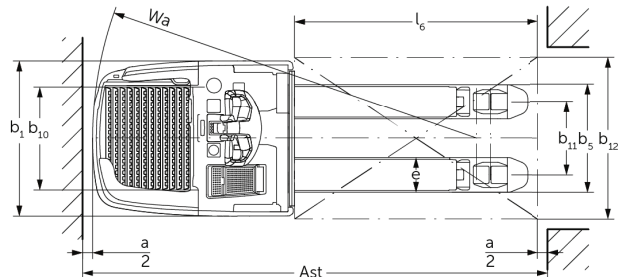
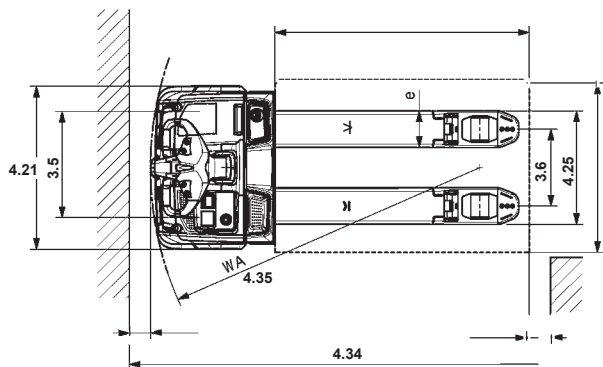

# Technical data

as of: 03/2026

Characteristics					Jungheinrich				Jungheinrich						
					ERE 125i				ERE 225i						
1.1	Manufacturer														
1.2	Model														
1.3	Drive				electric				electric						
1.4	Type of operation				tiller				tiller						
1.5	Load capacity / rated load		Q	lb	kg	5,512		2,500		5,512		2,500			
1.6	Load center distance		c	in	mm	24.0		600		24.0		600			
1.8	Load distance		x	in	mm	35.3 <sup>4)</sup>		897 <sup>4)</sup>		35.4 <sup>5)</sup>		898 <sup>5)</sup>			
1.9	Wheelbase		y	in	mm	48.7 <sup>4) 6)</sup>		1,237 <sup>4) 6)</sup>		49.4 <sup>5)</sup>		1,255 <sup>5)</sup>			
Weights	2.1 Service weight without battery <sup>8)</sup>			lb	kg	1,235		560		1,565		710			
	2.2 Axle loading, loaded front / rear			lb	kg	4,209	2,546	1,909	1,155	4,233 / 3,064		1,920 / 1,390			
	2.3 Axle loading, no load, load / drive			lb	kg	302	933	137	423	309 / 1,477		140 / 670			
Wheels, Chassis	3.1 Tires				polyurethane (PU)				polyurethane (PU)						
	3.2 Tire size, drive				mm	Ø 230 x 77				Ø 230 x 77					
	3.3 Tire size, load				mm	Ø 85 x 110 / Ø 85 x 85				Ø 85 x 110 / Ø 85 x 85					
	3.4 Tire size, caster				mm	Ø 140 x 57				Ø 140 x 57					
	3.5 Wheels, number, drive / caster / load <sup>7)</sup>				1 / 2 / 2				1 / 2 / 2						
	3.6 Tread width, drive side		b <sub>10</sub>	in	mm	20.2		512		20.2		512			
	3.7 Tread width, load side		b <sub>11</sub>	in	mm	14.3		363		14.3		363			
Dimensions	4.4 Maximum fork height from ground					in	mm	8.1		207		8.1		207	
	4.9 Height of tiller handle in drive position min./max.		h <sub>14</sub>	in	mm	44.8 / 55.9		1,137 / 1,419		47.8 / 50.2		1,215 / 1,275			
	4.15 Lowered fork height		h <sub>13</sub>	in	mm	3.3		85		3.3		85			
	4.19 Overall length			in	mm	86.1 <sup>2) 3) 6)</sup>		2,188 <sup>2) 3) 6)</sup>		84.2 <sup>3)</sup>		2,139 <sup>3)</sup>			
	4.20 Length to fork face		l <sub>2</sub>	in	mm	40.9 <sup>2) 3) 6)</sup>		1,038 <sup>2) 3) 6)</sup>		38.9 <sup>3)</sup>		989 <sup>3)</sup>			
	4.21 Overall chassis width		b <sub>1</sub> /b <sub>2</sub>	in	mm	30.3		770		30.3		770			
	4.22 Fork dimensions – thickness / width <sup>1)</sup>		s / e / l	in	mm	2.2 / 6.8 / 45.3		55 / 172 / 1,150		2.2 / 6.8 / 45.3		56 / 172 / 1,150			
	4.25 Overall width across forks		b <sub>5</sub>	in	mm	20 / 21 / 22 / 27		510/535/550/670		20 / 21 / 22 / 27		510/535/550/670			
	4.32 Ground clearance center of wheelbase		m <sub>2</sub>	in	mm	1.2		30		1.1		29			
	4.34 Aisle width for right angle stack (40 x 48 inch lengthways) <sup>2) 3) 6)</sup>		Ast	in	mm	98.0		2,490		95.1		2,415			
4.35 Minimum outside turning radius <sup>2) 3) 4) 5) 6)</sup>		Wa	in	mm	77.5		1,968		74.6		1,894				
Performance	5.1 Travel speed, loaded / unloaded			mph	km/h	5.6 / 5.6		9.0 / 9.0		5.6 / 7.5		9.0 / 12.0			
	5.1.1 Travel speed, loaded / unloaded (drivePLUS)			mph	km/h	-		-		5.6 / 8.7		9.0 / 14.0			
	5.2 Lift speed, loaded / unloaded			fpm	m/s	11.8 / 15.7		0.06 / 0.08		11.8 / 15.7		0.06 / 0.08			
	5.3 Lowering speed, loaded / unloaded			fpm	m/s	13.8 / 9.8		0.07 / 0.05		23.6 / 9.8		0.12 / 0.05			
	5.8 Maximum gradeability loaded / unloaded				%	8 / 16				8 / 16					
	5.10 Brakes – service					generative				generative					
Electrical	6.1 Drive motor (rating 60 minutes)			HP	kW	3.8		2.8		3.8		2.8			
	6.1.1 Drive motor (rating 60 minutes) drivePLUS			HP	kW	-		-		4.3		3.2			
	6.2 Lift motor rating at S <sub>3</sub>			HP	kW	3.0		2.2		3.0		2.2			
	6.4 Battery voltage / nominal <sup>8)</sup>			Volts	Ah	24		100		24		260			
	6.5 Integrated Battery Weight <sup>8)</sup>			lb	kg	77		35		220		100			
	6.6.1 Energy consumption according to DIN EN 16796				kWh/h	0.36				0.45					
	6.6.2 CO <sub>2</sub> equivalent as per EN 16796				kg/h	0.2				0.3					
6.7 Turnover output according to VDI 2198			US t/h	t/h	215		195		231		210				

- 1) Additional dimensions / sizes available
- 2) For folding platform configuration up / down ERE 125i, - 18.6 in. (472 mm) / - 2.2 in. (56 mm)
- 3) For fixed platform (compact) ERE 125i / ERE 225i, - 4.5 in. (114 mm) / - 4.1 in. (103 mm)
- 4) Load section lowered ERE 125i: + 2.6 in. (67 mm)
- 5) Load section lowered ERE 225i: + 2.6 in. (66 mm)
- 6) With S battery compartment ERE 125i: + 2.0 in. (50 mm)
- 7) Tandem load wheel optional
- 8) Power pack offerings ERE 125i: 100Ah 35kg (77 lbs.); 150Ah 47kg (104 lbs.); 200Ah 56kg (122 lbs.)
- 9) Power pack offerings ERE 225i: 130Ah 54kg (119 lbs.); 260Ah 100kg (220 lbs.)

Note: Equipping this model (these models) with a power source (e.g. Lithium-ion, Hydrogen Fuel cell, etc.) that has not been previously approved by the factory is considered a modification. Per OSHA 1910.178 and ANSI/ITSDF B56.1, please consult with your factory representative prior to installing any non-OEM power source that has not been previously approved.

This specification sheet only provides technical values for the standard truck. Non-standard tires, different masts, additional equipment, etc. could produce other values. Rights reserved for technical changes and improvements.

# The Jungheinrich Advantage



## Efficiency

Maximum performance thanks to innovative technology.

The battery concept offers a high degree of flexibility and adapts to your storage needs. The lithium-ion technology remains efficient even at low temperatures in cold-store applications. Jungheinrich-produced lithium-ion battery has LFP (Lithium-iron Phosphate) chemistry for optimized efficiency.

### Flexible battery concept

- High capacity and adaptability from 100 Ah to 200 Ah with the ERE 125i, and 130Ah to 260Ah with the ERE 225i.
- Powerful 35-A built-in charger for booster charging at any socket, even during short breaks.
- High availability thanks to short charging times.

### Powerful drive concept

- Powerful acceleration and high top speed.
- Greater driving performance with load-dependent curveCONTROL.
- Regenerative braking with energy recovery.

### Ergonomic solutions

- Trailer Detection Sensor System with automatic speed reduction when driving into trailers minimizes impacts and increases driving comfort (optional).
- Platform suspension can be adjusted according to the weight of the operator (optional).
- Generous space with sidestanding design promotes healthy posture.
- Optional comfort charging socket increases ease of use.



## Control

High level of safety for employees and goods.

The ergonomic stand-on platform provides restraint and protection while providing plenty of space for the operator. Intelligent assistance systems help increase productivity.

### Intelligent assistance systems

- High load stability due to coupling of the support wheels (ProTracLink).
- Sensor with enclosed space detection for automatically reducing speed when entering the truck-trailer (optional).
- Floor-Spot mounted within the truck contour (optional).

### Additional features

- High variety of stand-on platforms with spacious design.
- Additionally cushioned stand-on platform with driver weight dependent adjustment.
- Optimized cornering speed due to curveCONTROL.
- Improved visibility in poorly lit areas thanks to optional spotlight on the options bracket.



## Individuality

Can be adapted to a wide range of applications.

With numerous customization options, you can design the equipment according to your needs – from increased efficiency and additional features to ergonomic solutions.

### Individually adjustable

- Different stand-on platform variants to satisfy individual requirements.
- Adaptable travel program pre-sets with speeds up to 5.6 mph (9 km/h) with the ERE 125i, and 8.7 mph (14 km/h) with the ERE 225i.
- Capacity up to 5,500 lbs. (2.5 t).
- Extensive accessories for individual tailoring.
- Sturdy, universal options bracket, e.g. for radio data transmission components.
- Optional sprung stand-on platform reduces vibration felt by the operator.

### Parts when you need them

- Jungheinrich's Parts Fast or Parts Free Guarantee ensures next-business-day delivery by 5:00 PM of all Jungheinrich parts in the United States, or they're free, including freight. For customers in Canada and Mexico, the guarantee ensures shipping of parts within 24 hours from the time the order was placed by the dealer. See your local Jungheinrich dealer for program details.

\* Programs may be subject to change without notice and may vary by region. Please ask your local Jungheinrich dealer for complete terms and conditions.

\*\* The product shown may be different than the actual configuration based on market requirements.